

PRODUCT DATA SHEET

Sika® FillerBoard-50 PE

CLOSED CELL POLYETHYLENE FILLERBOARD

DESCRIPTION

Sika® FillerBoard-50 PE is a closed cell, crossed linked, non-absorbent polyethylene expansion joint filler board for use in expansion and isolation joints in concrete and masonry structures. Jointflex is UV resistant, has excellent weatherability, is non-absorbent and has excellent properties allowing it to be used in water retaining and excluding structures where, potable, salt, chlorine and sewerage water is prevalent.

USES

- Slab on ground
- Brickwork and blockwork
- Reinforced concrete structures
- Concrete roads & pavements
- Suspended slabs
- Basements and tunnels
- Water retaining and excluding structures
- Dams & reservoirs

CHARACTERISTICS / ADVANTAGES

- Non-absorbent
- Lightweight
- Excellent weatherability
- Resistant to ultraviolet light
- No bitumen content
- Ability to compress and recover
- Non extruding from joint movement
- Suitable for submerged or trafficable joints

PRODUCT INFORMATION

Packaging	2m x 1m Available thickness: 10, 12, 15, 20 and 30 mm Sizes from 2-50 mm are cut to order	
Density	50 kg/m ³	(ISO 845)

TECHNICAL INFORMATION

Teat Strength	1.0 N/nm	(DIN 53507)
Tensile Strength	0.44 MPa	(ISO 1798)

Elongation at Break	100%	(ISO 1798)
Compressive Set	(22 n, 25 %, 25 °C) after compression release :	
	0.5 h	< 14 % (ISO 1856)
	24 h	< 6 % (ISO 1856)
Compression Stress	10 %	34 KPa (ISO 3386)
Strain at Deflection	25 %	59 Kpa (ISO 3386)
	50 %	125 Kpa (ISO 3386)
Water Absorption after 28 d	<3 Vol%	A

APPLICATION INFORMATION

Typical Application

STANDARD DETAILS OF WALL APPLICATIONS

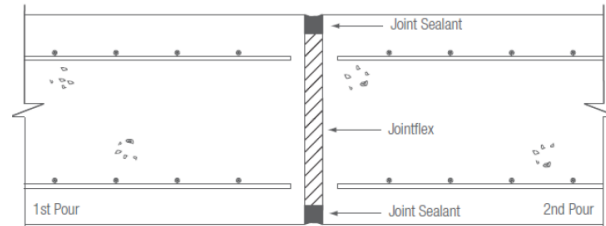

GENERAL PURPOSE

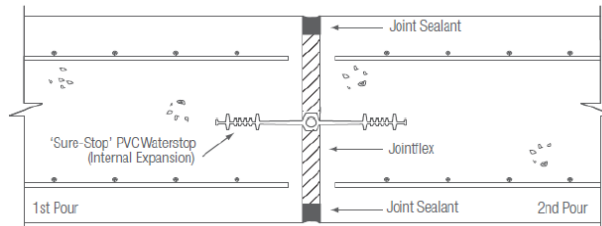

WATER RETAINING/EXCLUDING

STANDARD DETAILS OF GROUND SLAB APPLICATIONS

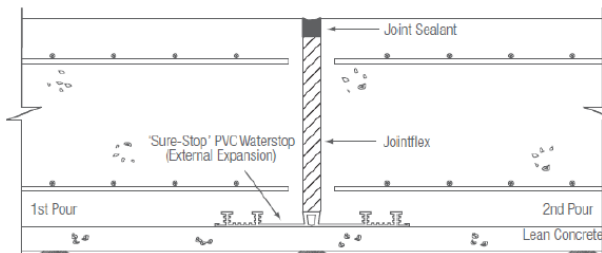
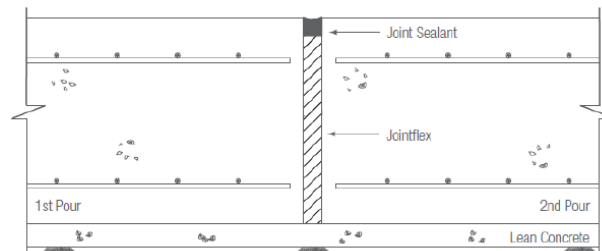

WATER RETAINING/EXCLUDING

APPLICATION INSTRUCTIONS

APPLICATION METHOD / TOOLS

Sika® FillerBoard-50 PE is cut to size in sheet form with a sharp retractable blade.

Sheets and rolls are adhered to the first concrete structure by a contact adhesive.

Adhesive is applied directly to the sheet in 50mm diameter 'spots' @ 300mm centers (approximately) or as required. Also refer to our installation method, available upon request.

BASIS OF PRODUCT DATA

All technical data stated in this Product Data Sheet are based on laboratory tests. Actual measured data may vary due to circumstances beyond our control.

LOCAL RESTRICTIONS

Please note that as a result of specific local regulations the declared data and recommended uses for this product may vary from country to country. Please consult the local Product Data Sheet for the exact product data and uses.

ECOLOGY, HEALTH AND SAFETY

For information and advice on the safe handling, storage and disposal of chemical products, users shall refer to the most recent Safety Data Sheet (SDS) containing physical, ecological, toxicological and other safety-related data.

LEGAL NOTES

The information, and, in particular, the recommendations relating to the application and end-use of Sika products, are given in good faith based on Sika's current knowledge and experience of the products when properly stored, handled and applied under normal conditions in accordance with Sika's recommendations. In practice, the differences in materials, substrates and actual site conditions are such that no warranty in respect of merchantability or of fitness for a particular purpose, nor any liability arising out of any legal relationship whatsoever, can be inferred either from this information, or from any written recommendations, or from any other advice offered. The user of the product must test the product's suitability for the intended application and purpose. Sika reserves the right to change the properties of its products. The proprietary rights of third parties must be observed. All orders are accepted subject to our current terms of sale and delivery. Users must always refer to the most recent issue of the local Product Data Sheet for the product concerned, copies of which will be supplied on request.

PT. SIKA INDONESIA

Jl. Raya Cibinong-Bekasi km. 20.

Cileungsi, Bogor 16820 - Indonesia

Telp. +62 21 8230025

Fax. +62 21 8230026

Website: idn.sika.com

email: sikacare@id.sika.com



PRODUCT DATA SHEET

Sika® FillerBoard-50 PE

October 2017

02070399010000001